

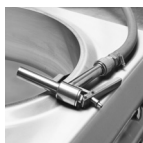

GIGAMIX POWER PRO

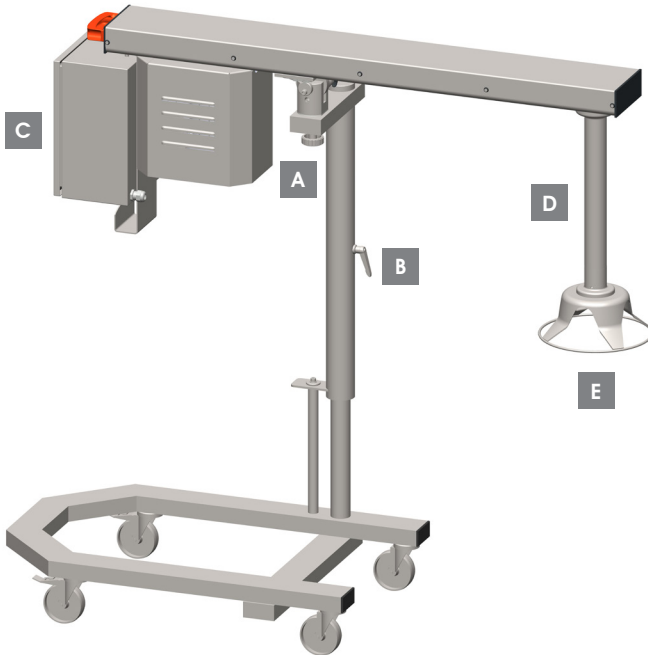

GIGAMIX DESCRIPTION



A Tightening knob

B Clamping handle

C Complete control unit

D Stainless steel mixer tube

GIGAMIX DESCRIPTION

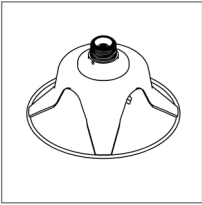

E **TB012** – Stainless steel guard

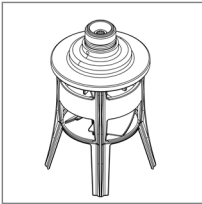

F **TB0013** – Potato tool masher

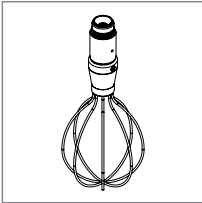

G **TB014** – Whip attachment

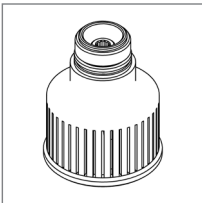

H **TB004** – Blender

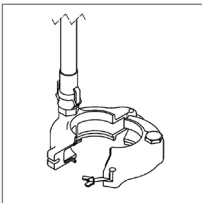

I **TB030** – Pump

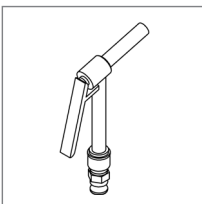

J **TB040** – Pump distribution gun

GIGAMIX TECHNICAL FEATURES

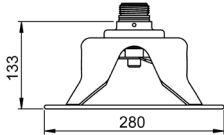
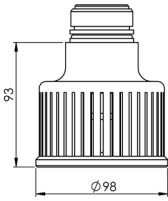
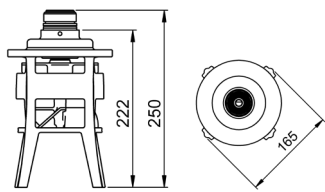
Voltage	<ul style="list-style-type: none"> • 230 V tri • 400 V tri + neutral • 230V mono
Power	<ul style="list-style-type: none"> • TB001 – TB005 – TB008 – TB020 : 4 000 RPM • TB002 – TB006 – TB009 – TB021 : <ul style="list-style-type: none"> · V1 : 800 RPM · V2 : 1600 RPM · VAR : 2800-4000 RPM
Speed	4000 RPM
Mixer foot only	570 mm
Weight	67 kg
TB012 – Dimensions of mixer attachment	
TB004 – Dimensions of blender	
TB013 – Dimensions of potato tool masher	

GIGAMIX TECHNICAL FEATURES

TB030 – Dimensions of Dyna pump

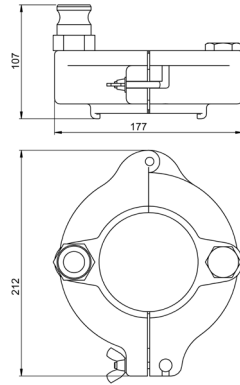

TB014 – Dimensions of whip

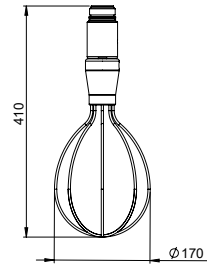

Dimensions

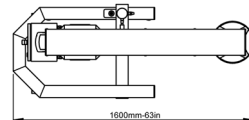
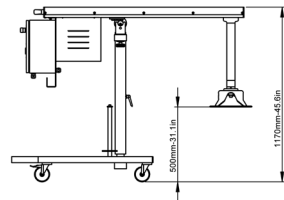

USER GUIDE – GIGAMIX

WARNING

Never operate your mixer without being immersed in liquid.

After using it, unplug the appliance.

Switch off the appliance before removing it from the liquid.

Do not allow liquid to enter the motor during use or cleaning.

Disconnect the machine when changing the accessories.

In case of accidental immersion of the motor, be careful of any electric shock: disconnect immediately the plug of the machine.

Warning, this product includes a moving blade. Take care when using it and when cleaning it as there is a risk of cuts.

This appliance may be used by children of at least 8 years of age and by persons with reduced physical, sensory or mental capacities or without experience or knowledge if they are correctly supervised or if they have been given instructions on how to use the appliance safely, and if they correctly understand the risks involved. Children must not play with the appliance. Cleaning and care by the user must not be performed by unsupervised children.

USE

Super mixer for large capacity applications.

Stainless steel construction offers many years of hygienic, uninterrupted food preparation.

Constructed with heavy duty locking casters and tilting mechanism which allow easy transport, safe and secure operation and convenient storage.

- Distance between chassis and mixer tube assembly : 800 mm / 31,5»
- Distance between bottom of mixer bell and floor : minimum = 460 mm / 18» maximum = 750 mm / 30»

PREPARATION WITH MIXER ATTACHMENT

It can carry out most preparations using its only blade. It has been designed for dealing with big quantities.

It can be used to make and emulsify sauces.

It can be used to blend and mix large quantities of excellent soups, but also: panadas, pancake mix, mayonnaises, etc.

PREPARATION WITH BLENDER ATTACHMENT

It allows to crush, grind and smooth delicious soups, veloutés, fruit creams to get quickly a smooth, unctuous and perfect texture, directly in the pot.

PREPARATION WITH WHIP ATTACHMENT

This Gigamix mixing whisk tool is ideal for mixtures using dehydrated potato, dehydrated soup, etc ... It guarantees a consistent and perfect mix.

The mixing whisk tool requires the base variable speed option.

USE OF THE PUMP

With its innovative process, the DYNAMIC transfer pump is perfectly adapted to the GIGAMIX blender attachment and allows to transfer quickly and effortlessly the mixed preparation into the packaging area or to empty the pot.

The transfer pump needs to be used with blender attachment.

USER GUIDE – GIGAMIX

PREPARATION WITH POTATO TOOL MASHER

It allows you to mix a creamy purée with entire potatoes directly in pots.

Used for many purées and vegetable creams: carrots, tomato sauce, bette, salad dressings, split peas, navet, cauliflowers.

The potato tool masher requires « variable speed » option.

This appliance is only to be used for food preparations: for any other use, please contact us.

OPERATION

POSITION A

Position for dismantling the bell.

In this position the giraffe no longer works because there is an electrical safety.

However you should still disconnect sector before putting the giraffe into this position.



POSITION B

Working position:

In this position, the GIGAMIX giraffe can be used normally.

You can adjust the H diving height by unscrewing the B trigger and by:

- Raising the jib of the giraffe to lift it
- Pressing on the jib of the giraffe in order to descend it using the pedal.

Don't forget to screw the B trigger back again to block the giraffe at the requested height.

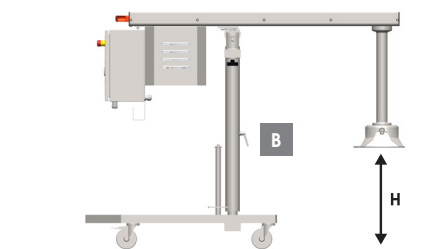

POSITION C

Storage position:

Unplug the giraffe before putting it into this position.



USER GUIDE – GIGAMIX

FROM A POSITION TO ANOTHER

1. Slightly move the jig to unlock the handle ❶.
2. Rotate the jig to the expected position and the clic signifying the locking of the jig ❷.
3. Rotate the jig to the expected position and the clic signifying the locking of the jig.

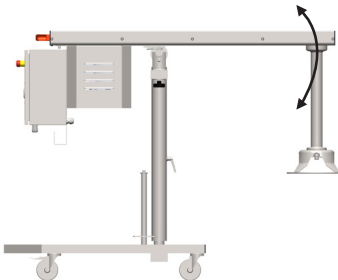
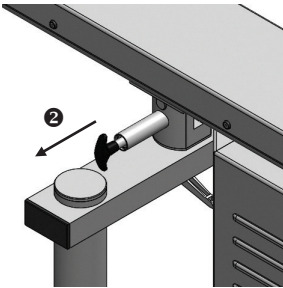
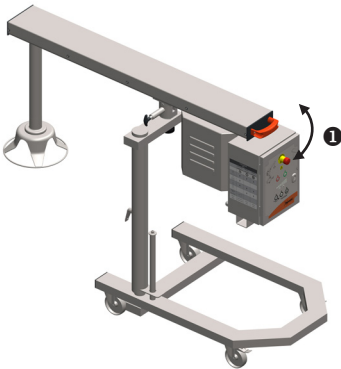
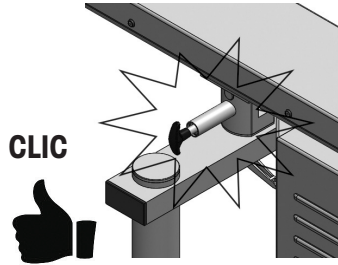

STARTING UP

1. Adapt a plug (not supplied) on the power cable corresponding to the installed socket.
2. For TB001, TB005, TB008 and TB020 versions, when you switch it on, check the way the blade rotates. If the way of rotation is not correct, disconnect the plug from the mains and reverse 2 wires.

Your GIGAMIX is ready to operate.

STANDARD CONTROL UNIT

1. Check that the emergency stop button ❸ isn't pressed. If so, turn the red hood to unlock it.
2. Press the ON-button ❷ to start the machine.
3. Press the OFF-button ❶ to stop the machine.
4. Press the emergency stop button ❸ if necessary. Do not forget to rearm the button by pulling the red hood.

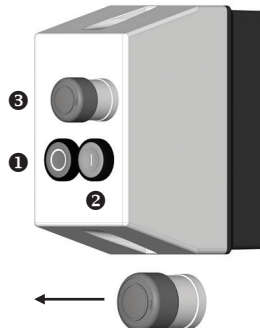

USER GUIDE – GIGAMIX

CONTROL UNIT WITH VARIABLE SPEED



1. Check that the emergency stop button 7 isn't pressed. If so, turn the red hood to unlock it.
2. Select the mode :
 - Variable speed 1
 - Fixed speed 1
 - Fixed speed 2
3. Press the ON button 4
4. Select the «variable speed» mode 1 and adjust the speed by pressing the buttons « + » or « - » 6.



5. Stop the GIGAMIX by pressing the OFF button 5.
6. In case of emergency, press the emergency stop button 7. To restart the machine, do not forget to reset the emergency stop button : pull on the red cover and then press on the stop button 5.



DISMANTLING OF THE ATTACHMENT

Once unplugged, unscrew the attachment in the anticlockwise direction with the disassembling key (code 9388).

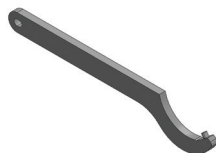

Disassembling key (code 9388)

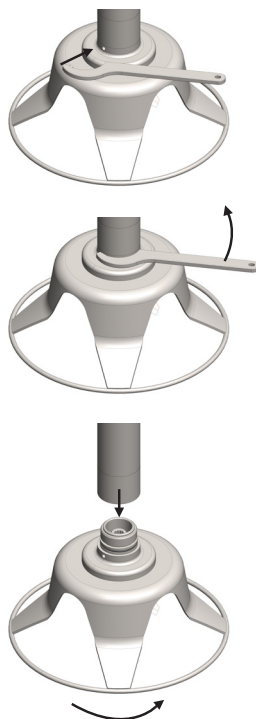

Take all the necessary precautions when removing the cover and the blade (TB0004) (some parts are sharp).

USER GUIDE – GIGAMIX

Proceed in the same way with the other accessories.



*Blender accessory
(code TB004)*



*Potato masher accessory
(code TB013)*



*Whisk accessory
(code TB014)*

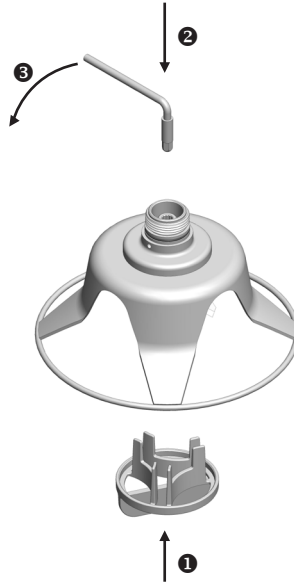

Take all the necessary precautions when removing the cover and the blade (TB004) (some parts are sharp).

DISMANTLING OF THE KNIFE (TB012)

Once the mixer tool is disassembled, lock the blade with the disassembly tool **1**.

Place the key inside the coupling of the accessory **2**.

Unscrew the blade in the direction of the arrow marked on the accessory **3**.

ASSEMBLY OF THE PUMP (TB030)

1. Open the pump.

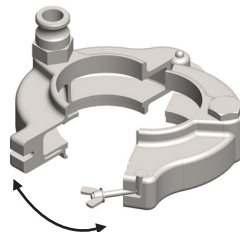

USER GUIDE – GIGAMIX

2. Surround the blender bell (TB004) with the pump.

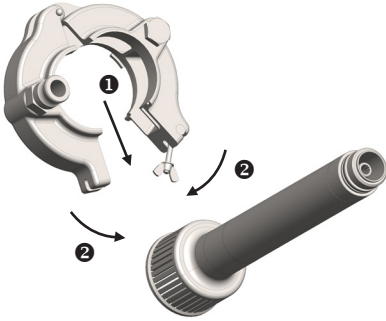

3. Lock the pump with the locker.

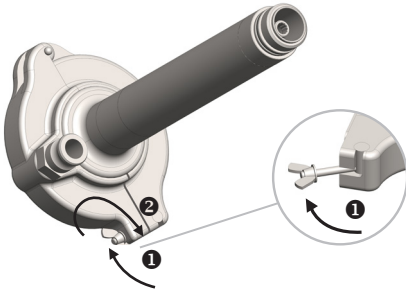

4. Fit the tube on the male fitting.

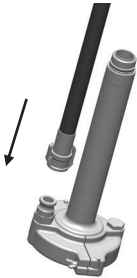

5. Lock the pump by lifting the handles of the hose pipe.

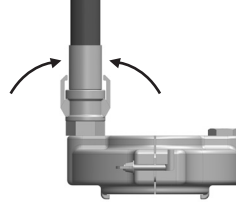

6. Disassemble the pipe and the pump in the opposite way from 1 to 5.

ASSEMBLY OF THE GUN (TB040)

1. Fit the gun in the female fitting.

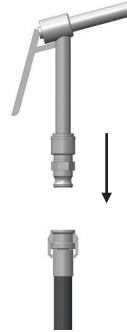

2. Lock the gun by lifting the handles of the hose pipe.

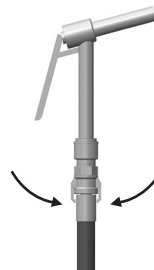



When using the gun with warm preparations, provide thermal protections for hands if necessary.

CLEANING

MAINTENANCE

1. Unplug the Giraffe.
2. Rinse the accessories and the mixer tube with a showerhead (do not use aggressive cleaning agents).
3. Never spray the motor block and the control casing.
4. The appliance can be cleaned using a sponge or a slightly damp cloth.

CAREFUL

Never wash the accessories without the protection cap.



fig. 1 / BLENDER accessory (code TB004) with protection cap.



During the cleaning of the accessories, be careful, there is a risk of cuts.

Do not let the accessories soak.

MAINTENANCE

AFTER EACH USE

Check the state of the power cord.

Disassemble the accessories of the machine (see DISMANTLING OF THE ATTACHMENT paragraph).

CAREFUL

Check there is no liquid inside the accessory.

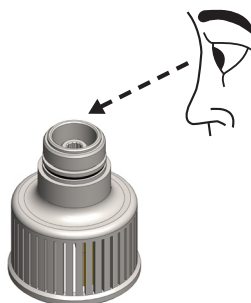

fig. 1 / Check the presence of liquid inside the accessory.

If there is liquid, replace the sealing ring (see the dismantling manual provided with the accessory or in your personal account on www.sav-dynamicmixers.com).

For the pump (code TB030), rinse carefully the inside of the hoses.

Check the general condition of the accessories before storing them in a dry and aerated place.

AFTER 150 HOURS OF USE OR EVERY MONTH

Check the condition of the attachments' bearings (codes 9357 and 9380).

Check the condition of the bearings, seals and O-rings (codes 0639, 0662 and 0665).

USER GUIDE – GIGAMIX

Check the wear on the accessories :

- Knife (code 9356) and the mixer bell (code 9351).
- Hammer (code 08999920) from the blender tool (code TB004).
- Strands of the whisk (code 9386).

Sharp the knife (code 9356) if necessary.

N.B. : see the dismantling guide in your personal account on www.sav-dynamicmixers.com

AFTER 1500 HOURS OR EVERY YEAR

Check the condition of the transmission parts:

- Belt (ref 0625).
- Pulley (ref 9362 and 9363).
- Ball bearing of the accessories.

Replace them if necessary.

Check that the setting systems (height adjustment and guidance) work well.

Check that the micro-switch (code 9373) works well.

Check that the wheels and brakes work well.

Check that the command case works well (ON/OFF, emergency stop button, restart option, adjustable speed system).

After 1500 hours or a year of use, it is necessary to replace the bearings of the foot attachment assembling (code 9350) or of the removable superior attachment (code 9330).

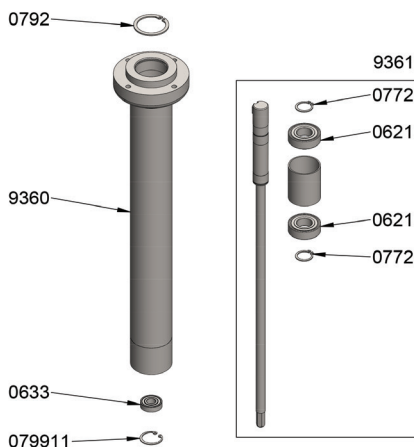

Foot attachment assembling (code 9350)

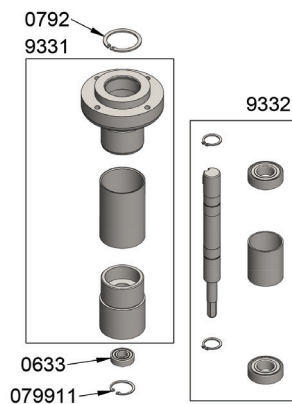

Removable superior attachment (code 9330)

N.B. : see the dismantling guide in your personal account on www.sav-dynamicmixers.com

USER GUIDE – GIGAMIX

ELECTRIC REQUIREMENTS

This appliance can have a three-phased power supply with or without neutral and is earthed.

The installation must be protected by a circuit breaker 4x16A 30mA for three-phased with neutral.

This appliance can have a single-phased power supply with protective earth conductor.

Then the installation must be protected by a circuit breaker N +25A for single-phased.

Check that the mains voltage and the voltage indicated on the appliance's identification plate are the same.

CERTIFICATE OF CONFORMITY CUSTOMER SERVICE AND WARRANTY

We certify that the Gigamix complies with EN 12853 fundamental requirements.

CUSTOMER SERVICE AND WARRANTY.

If your device does not work properly anymore or shows defects, please contact your distributor or send it to the following address :

DYNAMIC FRANCE S.A.S.

518 rue Léo Baekeland – B.P.57
85290 Mortagne-sur-Sèvre Cedex - FRANCE

Tél. +33 (0)2 51 63 02 72

Fax : +33 (0)2 51 63 02 73

e-mail : contact@dynamicmixers.com

Site internet : www.dynamicmixers.com

CANADA SERVICE CENTRE DYNAMIC INTERNATIONAL LTD.

3227 Boul. pitfield
Saint-Laurent - Québec H4S-1H3

Toll free phone : 1-800-267-7794

Toll free fax : 1-877- 668-6623

Local Phone : (514) 956 0127

Local Fax : (514) 956 8983

This device has a one-year manufacturing defect warranty, starting from the purchase date.

DYNAMIC warranty covers parts and labour.

The warranty covers the replacement of any defective part, but does not cover damage from dropping or impacts, damage caused by improper use, incorrect connection to the power supply, or the failure to follow the usage conditions described in the instructions.

To be valid, the warranty certificate must be :

1. Certified by the seller (date and stamp).
2. Sent with the device in case of repair under warranty.

INSTRUCTIONS FOR THE REPAIR OF YOUR DEVICE.

If your machine does not work normally, please ask advice to your distributor who can often help you, or send the machine, well packed, to:

DYNAMIC FRANCE S.A.S.

518 rue Léo Baekeland – B.P.57
85290 Mortagne-sur-Sèvre – France

Every return is at your charge.

ESPECIALLY FOR THE USA AND CANADA

This machine is in accordance with CE standards and:



USER GUIDE – GIGAMIX

CUSTOMER SERVICE AND WARRANTY

Should your unit require service, contact your distributor for the nearest authorized service centre if you wish your unit to be serviced by the manufacture ship it to:

CANADA SERVICE CENTRE DYNAMIC INTERNATIONAL LTD.

3227 Boul. pitfield
Saint-Laurent - Québec H4S-1H3

Toll free phone: 1-800-267-7794

Toll free fax: 1-877- 668-6623

Local Phone: (514) 956 0127

Local Fax: (514) 956 8983

USA SERVICE CENTRE DYNAMIC INTERNATIONAL LTD.

1320 route 9 # 1352
Champlain, NY - 12919

Toll free phone:1-800-267-7794

Toll free fax: 1-877- 668-6623

DYNAMIC FRANCE S.A.S.

518 rue Léo Baekeland – B.P.57
85290 Mortagne-sur-Sèvre Cedex - FRANCE

Tél. +33 (0)2 51 63 02 72

Fax: +33 (0)2 51 63 02 73

e-mail: contact@dynamicmixers.com

Unauthorized work on the products during the warranty period will void this warranty.

The portion below must be sent to the Service Centre within 10 days from the purchase date.

WARRANTY

Your new Dynamic product is warranted to the original purchaser, for a period of one year, from the date of purchase. DYNAMIC warrants products to be free of manufacturing defects for a period of one year from the day of original shipment, covering all parts and labor. Damage caused by improper use, accident and/or abuse are not considered to be manufacturing defects. DYNAMIC will repair or replace, at its discretion, defective products returned to an authorized warranty repair center, freight prepaid one way.

DIAGRAM WITHOUT VARIABLE SPEED CONTROL 230V TRI

POWER SUPPLY 230V DIRECT
TRIPHASED

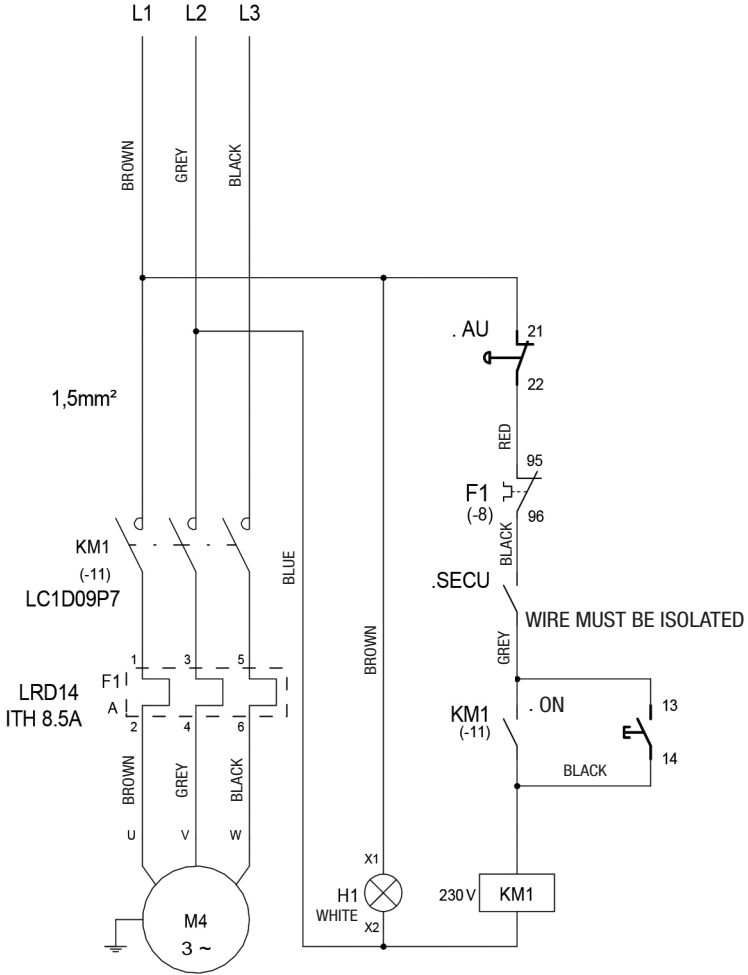

DELTA CONNECTION

- ⏏ (-8)
- ⏏ (-8)
- ⏏ (-8)
- ⏏ (-11)

DIAGRAM WITHOUT VARIABLE SPEED CONTROL 400V TRI + N

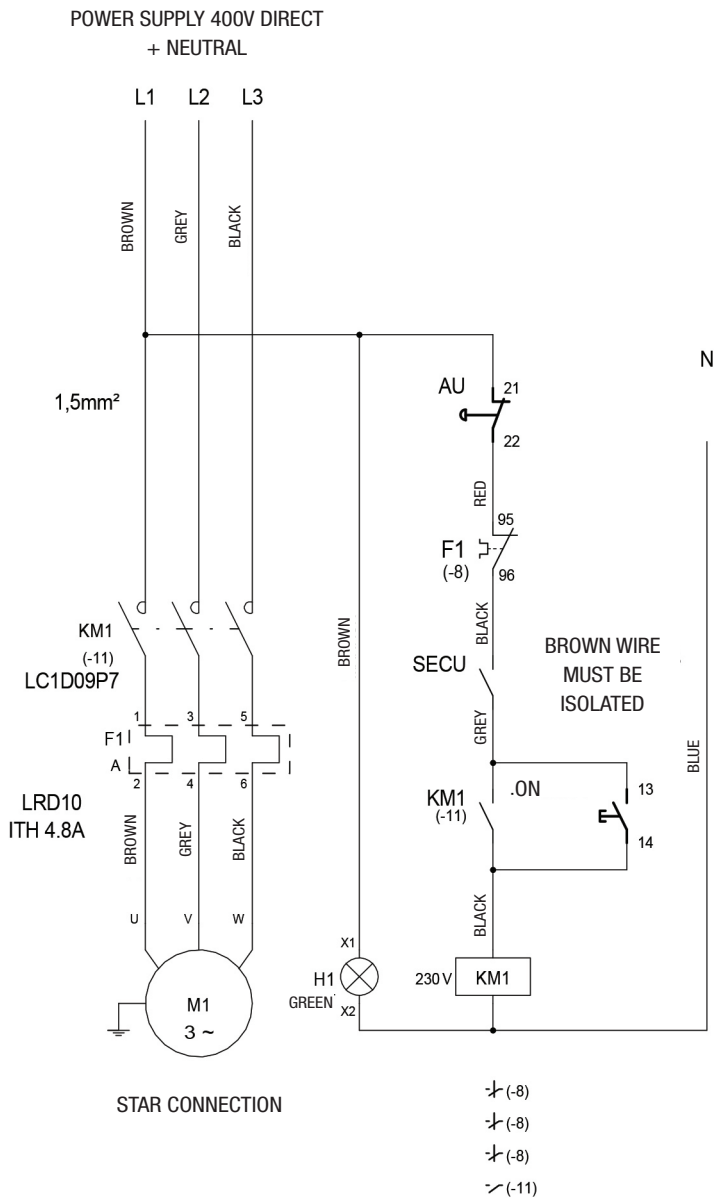

DIAGRAM WITH VARIABLE SPEED CONTROL 230V MONO

POWER SUPPLY 230V MONOPHASED
WITH VARIATOR

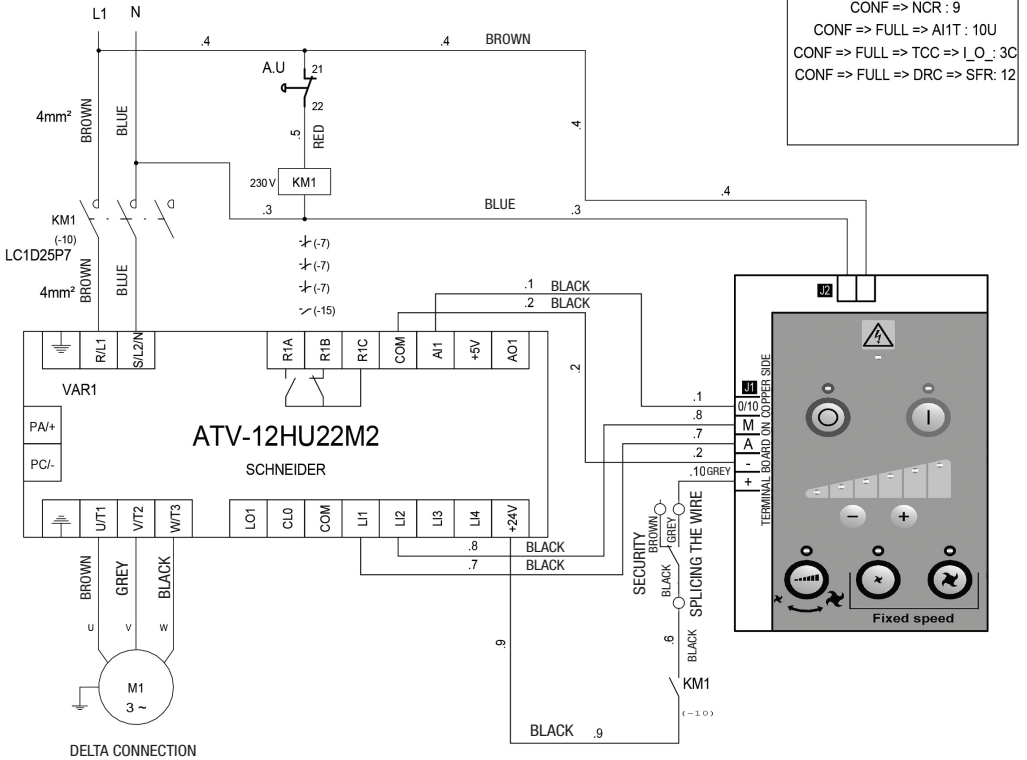

DIAGRAM WITH VARIABLE SPEED CONTROL 230V TRI

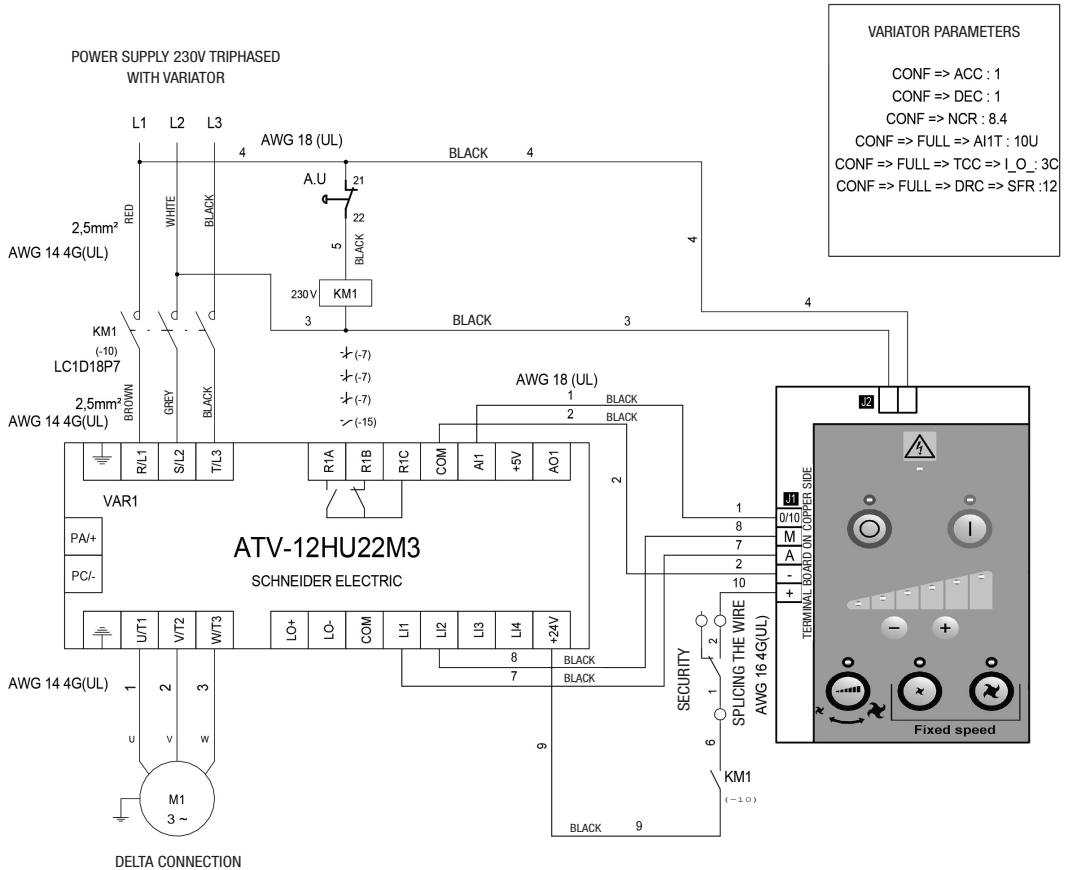
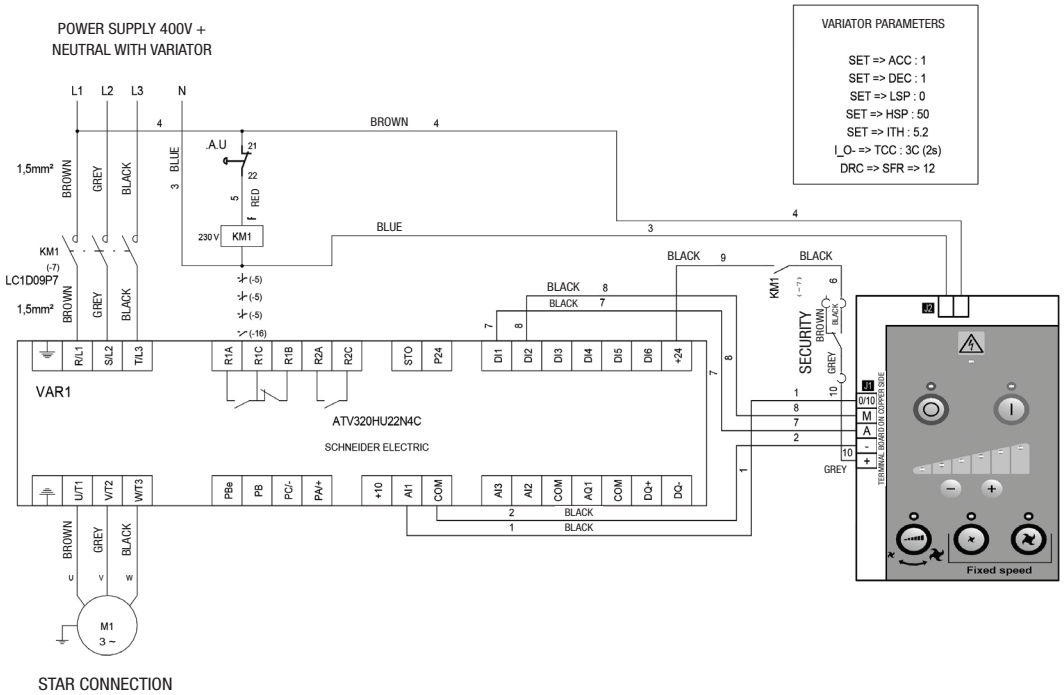

DIAGRAM WITH VARIABLE SPEED CONTROL 400V TRI + N



SCHEMATIC AND PART LIST

STANDARD FRAME

CODE	PART LIST
0793	DETACHABLE HANDLE
079916	TIGHTENING KNOB
07998	80X40 CAP
089953.V	RING 50 X 12 X 5 STAINLESS STEEL GIGAMIX
9346	JIB ASSEMBLING
9350	FOOT ASSEMBLY WITHOUT BELL
9352	PIN BRAKE ASSEMBLING
9353	WHEEL WITHOUT BRAKE + SCREW (UNIT)
9354	BRAKE WHEEL + SCREW (UNIT)
9355	FRAME + JIB HOLDER

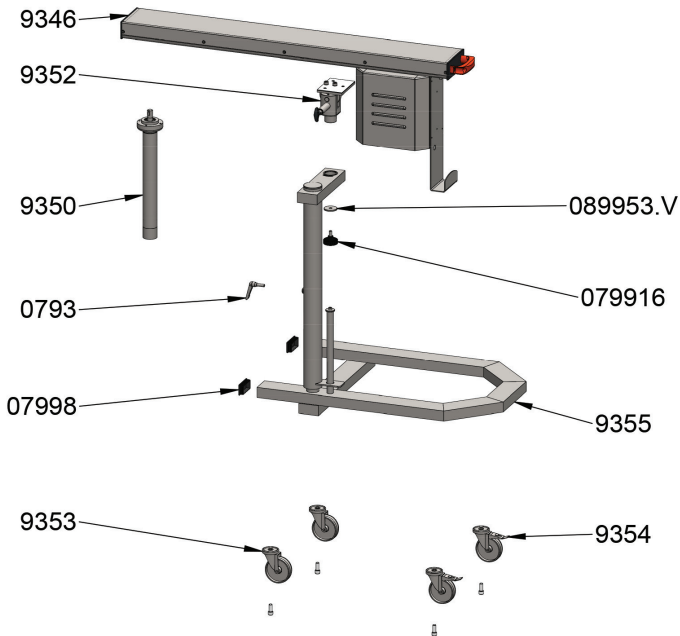

SCHEMATIC AND PART LIST

9352 - PIN-BRAKE ASSEMBLING

CODE	PART LIST
0773	PLAIN SCREW M8 X 30
089916	INSUTATING SHEET
089927	INTERPOLATED SHEET
089932	JIB PLATE HOLDER
9373	SWITCH + SCREW
9374	PIN-BRAKE + ECCENTRIC + CAM + CAM AXLE

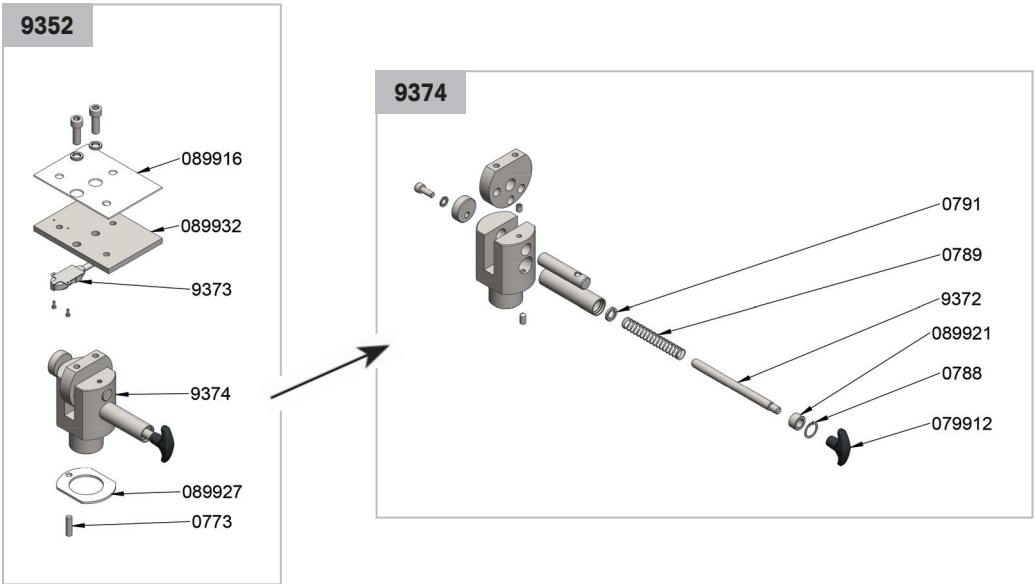

9374 - PIN-BRAKE + ECCENTRIC + CAM

CODE	PART LIST
0788	RUBBER RING FOR BRAKE THRUST
0789	COMPRESSION SPRING
0791	RUBBER RING FOR BRAKE AXLE
079912	BRAKE HANDLE
089921	BRAKE THRUST
9372	BRAKE AXLE

SCHEMATIC AND PART LIST

9346 - JIB ASSEMBLING

CODE	PART LIST
0625	TRANSMISSION BELT
0786	FRONT JIB CAP FOR GIGAMIX
0786P	BACK JIB CAP FOR GIGAMIX
079978	SCREW M4X40 (X2)
089914	JIB HOLDER
089915	COVER
089931	MOTOR HOUSING
9077	HANDLE
9078	HANDLE SCREWS
9362	DIRECTING PULLEY + HUB
9363	CONDUCTING PULLEY + HUB
9364	SCREW SET + WASHERS FOR MOTOR
9365	SCREW SET + WASHERS FOR FIXING JIB
9366	SCREW SET + WASHERS FOR AXLE BRAKE
9367	SCREW SET + WASHERS FOR TUBE
9368	SCREW SET + HOOD WASHER
9369	MOTOR
9370	SCREW SET + NUTS FOR SHEET ON JIB
9371	SCREW SET TO FIX SHEET ON MOTOR
9388	HOOK WRENCH

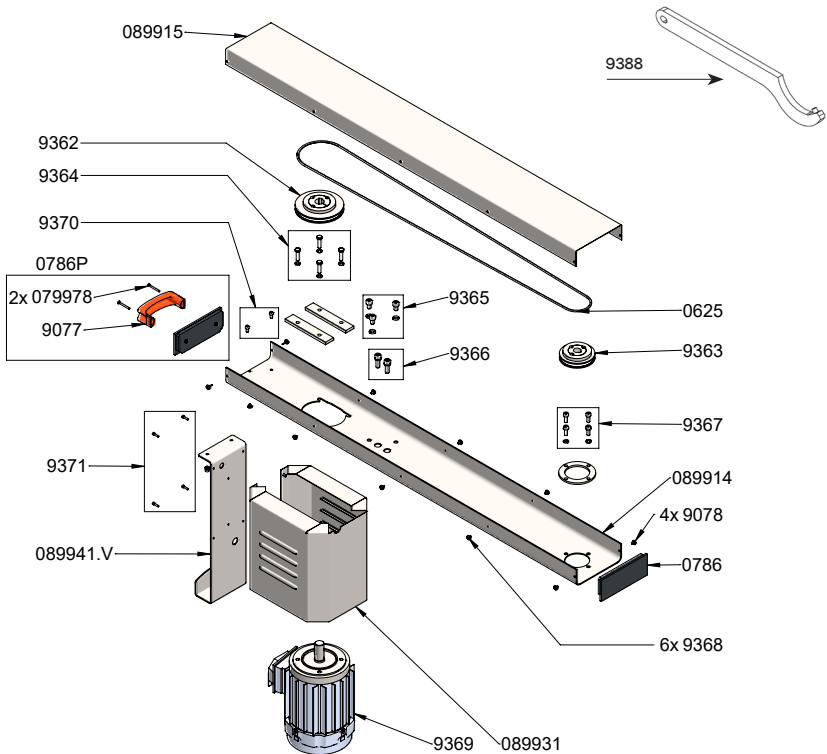

SCHEMATIC AND PART LIST

ELECTRIC CASE

CODE	PART LIST
9390	BOX CASE + PE
9390.2	STAINLESS STEEL BOX (SPEED 1 + SPEED 2 + VARIABLE SPEED)
9390.1	STAINLESS STEEL BOX (VARIABLE SPEED)
9391	MOTOR CONTACTOR
9391.1	MOTOR 3-PHASED CONTACTOR 220V
9391.2	MOTOR 1-PHASED CONTACTOR 220-240V
9392	3-PHASED 2.2KW VARIATOR
9392.1	VARIABLE SPEED DRIVER TRI 240 V 2.2 Kw
9392.2	ONE-PHASED VARIABLE SPEED DRIVER 240 V 2.2 Kw
9393	CONNECTION TERMINAL
9394	STOP PUSH BUTTON
9395	EMERGENCY PUSH BUTTON
9396	ON/OFF LIGHT
9397	ON/OFF PUSH BUTTON
9399	BOX CASE + PE VERSION MIA
93991	THERMIC RELAY
93992	GIGAMIX COMMAND CIRCUIT
93993	GIGAMIX 3-PHASED POWER CORD
93993.1	GIGAMIX 3-PHASED POWER CORD WITHOUT NEUTRAL
93993.2	GIGAMIX 1-PHASED POWER CORD
93994	GIGAMIX COMMAND CIRCUIT (SPEED1 + SPEED 2 + VARIABLE SPEED)
ETIQ0023	GIGAMIX FRONT LABEL
ETIQ0052	GIGAMIX USING LABEL

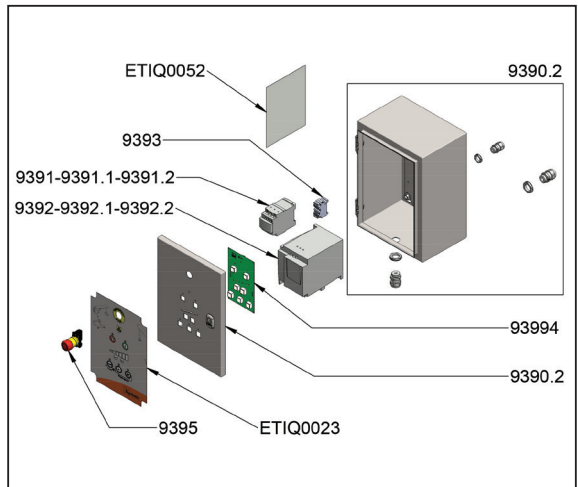
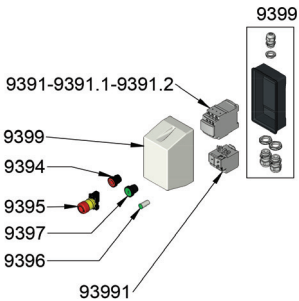

SCHEMATIC AND PART LIST

9350 - FOOT ATTACHMENT

CODE	PART LIST
0621	UPPER AND LOWER BEARING
0633	BALL BEARING
0772	GIGAMIX MIXER FOOT CIRCLIPS (2)
0792	RUBBER RING FOR UPPER BEARING HOLDER
079911	RUBBER RING CASE
9360	BEARING HOLDER + BRACE + CASE
9361	DRIVE SHAFT

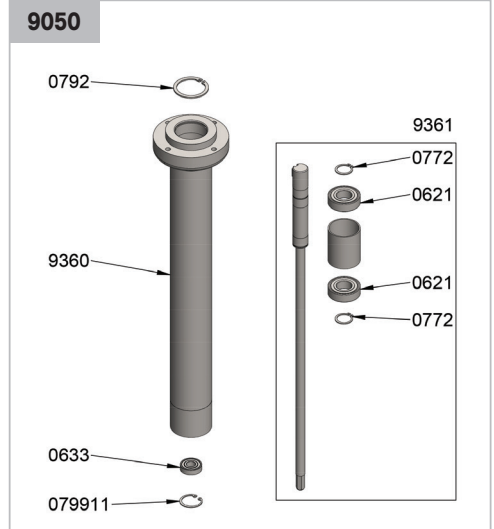

CODE	PART LIST
9330	UPPER REMOVABLE FOOT
9333	LOWER REMOVABLE FOOT
TB012	PROTECTION BELL

For versions TB008 and TB009.

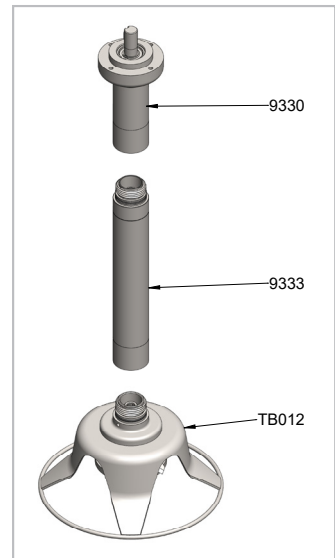

SCHEMATIC AND PART LIST

9330 - UPPER REMOVABLE FOOT

CODE	FR
0633	BALL BEARING
0792	RUBBER RING FOR UPPER BEARING HOLDER
079911	RUBBER RING CASE
9331	BEARING HOLDER + BRACE + CASE
9332	DRIVE SHAFT

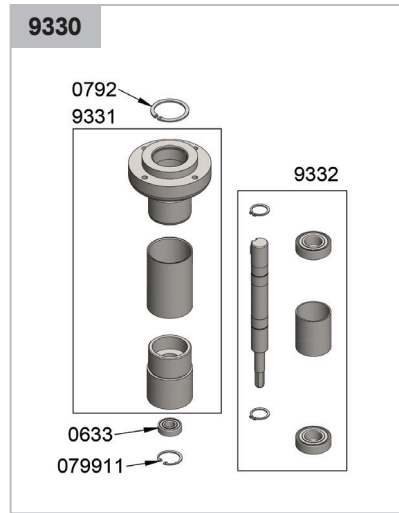

9333 - LOWER REMOVABLE FOOT

CODE	PART LIST
0633	BALL BEARING
0639	TORIC JOINT 42 X 2.5
0791	RUBBER RING FOR BRAKE AXLE
079911	RUBBER RING CASE
9334	DRIVE SHAFT
9335	SPACER + BUSH

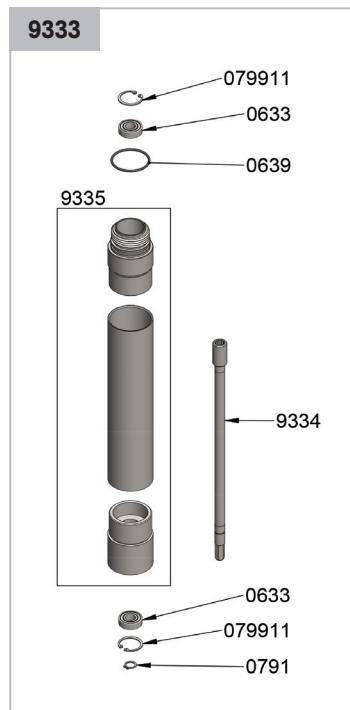

SCHEMATIC AND PART LIST

TB012 - MIXER TOOL

CODE	PART LIST
0618	SEALS FOR BEARING ASSEMBLY (2)
0639	TORIC JOINT 42 X 2.5
0640	TORIC JOINT 34 X2
0649	BEARING
0662	GIGAMIX DOUBLE LIPPED SEAL
0790	PLASTIC HANDLE
089912	INFERIOR BEARING ASSEMBLY TO SCREW GIGAMIX
089926	RING HOLDER
1485	DISASSEMBLY KIT FOR GIGAMIX TOOL
9302	PROTECTION CAP
9349	WATERPROOF SET(SEAL + BEARING + SCREW + CLIP)
9356	BLADE GIGAMIX
9357	LOWER SHAFT + BEARING + COUPLING + CLIPS
9358	PROTECTION BELL
9359	BELL ASSEMBLING SET OF SCREWS

For versions TB001 / TB002 / TB005 / TB006 / TB020 and TB021.

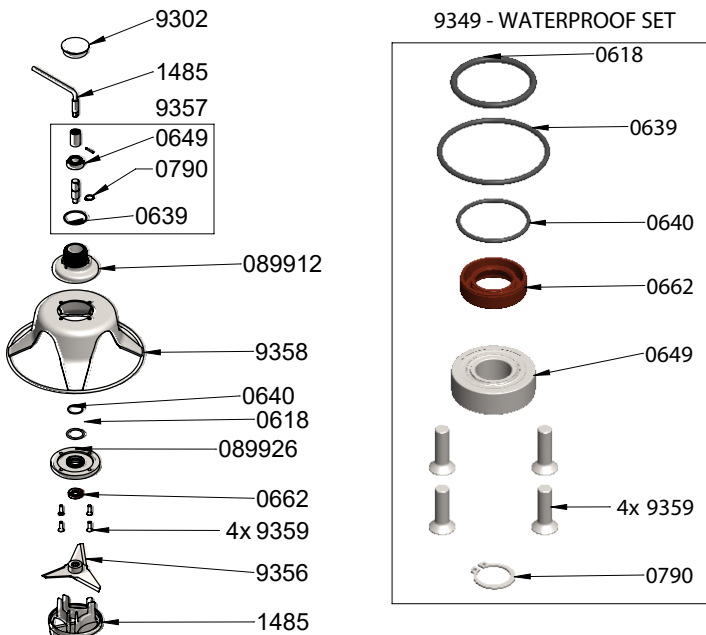

SCHEMATIC AND PART LIST

TB013 - POTATO TOOL MASHER

CODE	PART LIST
0618	SEALS FOR BEARING ASSEMBLY (2)
0639	TORIC JOINT 42 X 2.5
0640	TORIC JOINT 34 X2
0649	BEARING
0790	PLASTIC HANDLE
089912	INFERIOR BEARING ASSEMBLY TO SCREW GIGAMIX
08999944	POTATO BLADE GIGAMIX
08999945	RICER BELL
1485	DISASSEMBLY KIT FOR GIGAMIX TOOL
9302	PROTECTION CAP
9357	LOWER SHAFT + BEARING + COUPLING + CLIPS
9359	BELL ASSEMBLING SET OF SCREWS

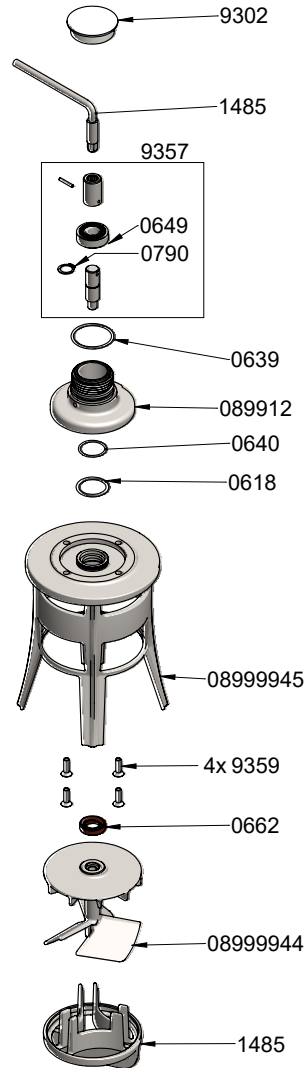

SCHEMATIC AND PART LIST

TB004 - BLENDER ATTACHMENT

CODE	DÉSIGNATION
0639	TORIC JOINT 42 X 2.5
0649	BEARING
0665	WATERPROOF SEAL
0790	PLASTIC HANDLE
079977	RUBBER RING
0899920	HAMMER
0899921	BLENDER GIGAMIX BELL
1485	DISASSEMBLY KIT FOR GIGAMIX TOOL
9302	PROTECTION CAP
9348	WATERPROOF KIT ACCESSORY BLENDER GIGAMIX
9357	LOWER SHAFT + BEARING + COUPLING + CLIPS

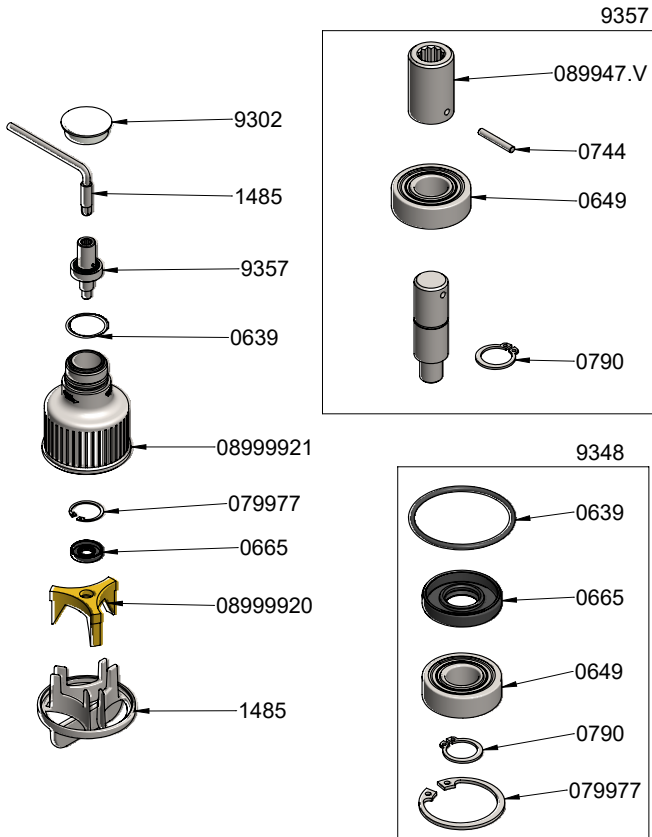

SCHEMATIC AND PART LIST

TB030 - DYNA PUMP

CODE	PART LIST
08999930	RIGHT HALF CLAMP
08999931	LEFT HALF CLAMP
08999932	3/4 STAINLESS MALE CAP
08999933	3/4 STAINLESS REDUCER FEMALE
08999935	PUMPE HINGE
08999936	3/4 MALE FITTING
08999937	HOSE NIPPLE CAMLOCK FITTINGS DN19
08999939	3/4 HOSE NIPPLE THREADED CONNECTION
08999940	STAINLESS STEEL HOSE CLAMP
08999941	PUMP DISTRIBUTION GUN
9347	PUMP LOCKER + WASHER + BUTTERFLY NUT
TB040	GUN GIGAMIX
TB045	HOSE PIPE / M
TB047	HOSE PIPE WITH 2 CAM AXLES (2.5M)

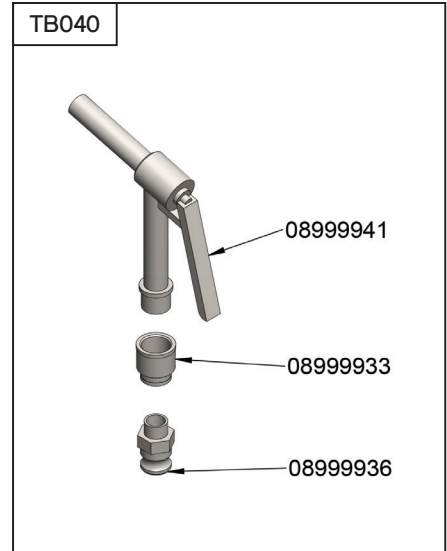
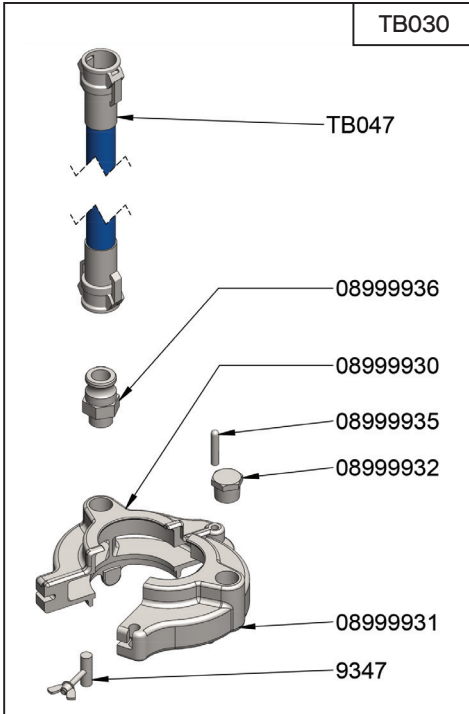

SCHEMATIC AND PART LIST

TB014 - FOOT ATTACHMENT ASSEMBLING

CODE	PART LIST
0639	TORIC JOINT 42 X 2.5
0649	BEARING
0665	WATERPROOF SEAL
0790	PLASTIC HANDLE
079977	RUBBER RING
089947.V	COUPLING SLEEVE
089986	MALE CASING
089996	EXIT SHAFT
93861	WHISK TOOL
9389	WHISK ATTACHMENT WITHOUT TOOL

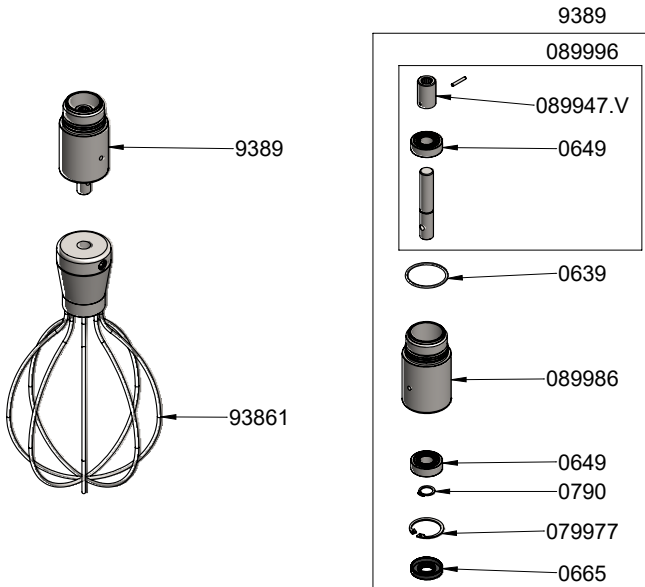

WARRANTY

- Hotel, Inn
 - Restaurant
 - Cafeteria
 - Bakery, Patisserie
 - Ice-cream manufacturer
 - Hospital
 - Other
-

• Name

.....

• Address

.....

• City

.....

• Zip code

.....

• Telephone

.....

DYNAMIC FRANCE S.A.S.

S.A.S. au capital de 216.780 Euros - RCS 416 450 435 - La Roche-sur-Yon

518 rue Léo Baekeland – B.P.57

85290 Mortagne-sur-Sèvre Cedex - FRANCE

Tel. +33 (0)2 51 63 02 72

Fax : +33 (0)2 51 63 02 73

E-mail : contact@dynamicmixers.com

www.dynamicmixers.com

Dealer's stamp

